

ダブルフェルール式銅管継手【黄銅製】

■ 締付型ハーフユニオン

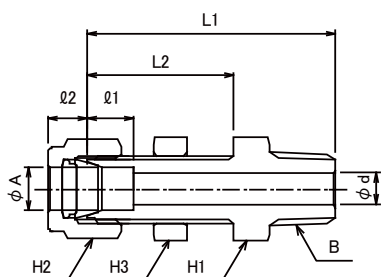
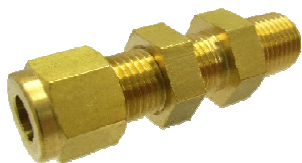

型 式	銅管外径 管用ねじ		本体長さ		最小孔径 d (mm)	差込深さ		対 辺			パネル 穴径 (mm)	最大パネル 厚さ (mm)
	A (mm)	B (R)	L1 (mm)	L2 (mm)		φ1 (mm)	φ2 (mm)	H1 (mm)	H2 (mm)	H3 (mm)		
GBMC-6M2R-BS	6	R1/8	45.5	28	5	8	7	17	14	17	11.5	13
GBMC-6M4R-BS	6	R1/4	47.5	28	5	8	7	17	14	17	11.5	13
GBMC-6M6R-BS	6	R3/8	49	28	5	8	7	17	14	17	11.5	13
GBMC-6M8R-BS	6	R1/2	53	28	5	8	7	22	14	17	11.5	13
GBMC-8M2R-BS	8	R1/8	47	29	6	9	8	17	16	17	13.2	13.5
GBMC-8M4R-BS	8	R1/4	49	29	6	9	8	17	16	17	13.2	13.5
GBMC-8M6R-BS	8	R3/8	50	29	6	9	8	17	16	17	13.2	13.5
GBMC-8M8R-BS	8	R1/2	54	29	6	9	8	22	16	17	13.2	13.5
GBMC-10M2R-BS	10	R1/8	48	30	6	10	9	19	19	22	16.2	14.5
GBMC-10M4R-BS	10	R1/4	50	30	8	10	9	19	19	22	16.2	14.5
GBMC-10M6R-BS	10	R3/8	51	30	8	10	9	19	19	22	16.2	14.5
GBMC-10M8R-BS	10	R1/2	55	30	8	10	9	22	19	22	16.2	14.5
GBMC-12M2R-BS	12	R1/8	51	32	6	12	10	26	23	26	19.5	16
GBMC-12M4R-BS	12	R1/4	53	32	8	12	10	26	23	26	19.5	16
GBMC-12M6R-BS	12	R3/8	54	32	10	12	10	26	23	26	19.5	16
GBMC-12M8R-BS	12	R1/2	58	32	10	12	10	26	23	26	19.5	16
GBMC-4T2R-BS	6.35	R1/8	46	28	5	8	7	17	14	17	11.5	13
GBMC-4T4R-BS	6.35	R1/4	48	28	5	8	7	17	14	17	11.5	13
GBMC-4T6R-BS	6.35	R3/8	49	28	5	8	7	17	14	17	11.5	13
GBMC-4T8R-BS	6.35	R1/2	53	28	5	8	7	22	14	17	11.5	13
GBMC-6T2R-BS	9.53	R1/8	48	30	6	9.5	8	19	17	19	14.8	14.5
GBMC-6T4R-BS	9.53	R1/4	50	30	7	9.5	8	19	17	19	14.8	14.5
GBMC-6T6R-BS	9.53	R3/8	51	30	7	9.5	8	19	17	19	14.8	14.5
GBMC-6T8R-BS	9.53	R1/2	55	30	7	9.5	8	22	17	19	14.8	14.5
GBMC-8T2R-BS	12.7	R1/8	51	32	6	12	10	26	23	26	19.5	16
GBMC-8T4R-BS	12.7	R1/4	53	32	8	12	10	26	23	26	19.5	16
GBMC-8T6R-BS	12.7	R3/8	54	32	10	12	10	26	23	26	19.5	16
GBMC-8T8R-BS	12.7	R1/2	58	32	10	12	10	26	23	26	19.5	16

※6M、4Tのみワッシャー付