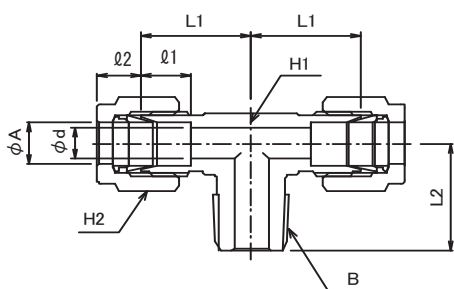

ダブルフェルール式銅管継手【黄銅製】
両口チーヅユニオン

型 式	銅管外径		管径ねじ		本体長さ		最小穴径	差込深さ		対 辺	
	A (mm)	B (R)	L1 (mm)	L2 (mm)	d (mm)	Ø1 (mm)	Ø2 (mm)	H1 (mm)	H2 (mm)		
GMBT-6M2R-BS	6	R1/8	19.5	20	5	8	7	14	14		
GMBT-6M4R-BS	6	R1/4	19.5	21	5	8	7	14	14		
GMBT-6M6R-BS	6	R3/8	22	26.5	5	8	7	17	14		
GMBT-6M8R-BS	6	R1/2	24	33	5	8	7	19	14		
GMBT-8M2R-BS	8	R1/8	19.5	20	6	9	8	14	16		
GMBT-8M4R-BS	8	R1/4	19.5	21	6	9	8	14	16		
GMBT-8M6R-BS	8	R3/8	22	26.5	6	9	8	17	16		
GMBT-8M8R-BS	8	R1/2	24	33	6	9	8	19	16		
GMBT-10M2R-BS	10	R1/8	23	22.5	6	10	9	17	19		
GMBT-10M4R-BS	10	R1/4	23	24.5	8	10	9	17	19		
GMBT-10M6R-BS	10	R3/8	23	26.5	8	10	9	17	19		
GMBT-10M8R-BS	10	R1/2	25	33	8	10	9	19	19		
GMBT-12M2R-BS	12	R1/8	25	26	6	12	10	19	23		
GMBT-12M4R-BS	12	R1/4	25	28	8	12	10	19	23		
GMBT-12M6R-BS	12	R3/8	25	30	10	12	10	19	23		
GMBT-12M8R-BS	12	R1/2	25	33	10	12	10	19	23		
GMBT-4T2R-BS	6.35	R1/8	19.5	20	5	8	7	14	14		
GMBT-4T4R-BS	6.35	R1/4	19.5	21	5	8	7	14	14		
GMBT-4T6R-BS	6.35	R3/8	22	26.5	5	8	7	17	14		
GMBT-4T8R-BS	6.35	R1/2	24	33	5	8	7	19	14		
GMBT-6T2R-BS	9.53	R1/8	23	22.5	6	9.5	8	17	17		
GMBT-6T4R-BS	9.53	R1/4	23	24.5	7	9.5	8	17	17		
GMBT-6T6R-BS	9.53	R3/8	23	26.5	7	9.5	8	17	17		
GMBT-6T8R-BS	9.53	R1/2	25	33	7	9.5	8	19	17		
GMBT-8T2R-BS	12.7	R1/8	25	26	6	12	10	19	23		
GMBT-8T4R-BS	12.7	R1/4	25	28	8	12	10	19	23		
GMBT-8T6R-BS	12.7	R3/8	25	30	10	12	10	19	23		
GMBT-8T8R-BS	12.7	R1/2	25	33	10	12	10	19	23		