

リング式銅管継手(計装用)

両口チーヅユニオン

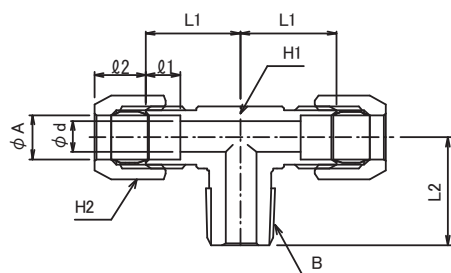

型 式	銅管外径 管用ねじ		本体長さ		最小穴径 d (mm)	差込深さ		対 辺	
	A (mm)	B (R)	L1 (mm)	L2 (mm)		φ1 (mm)	φ2 (mm)	H1 (mm)	H2 (mm)
GTSC-8101R-BS	6	1/8	18.5	20	5	7	9.5	14	14
GTSC-8102R-BS	6	1/4	18.5	21	5	7	9.5	14	14
GTSC-8103R-BS	6	3/8	21	27.5	5	7	9.5	17	14
GTSC-8104R-BS	6	1/2	23	30	5	7	9.5	19	14
GTSC-8201R-BS	8	1/8	18.5	20	5	7	9.5	14	14
GTSC-8202R-BS	8	1/4	18.5	21	6	7	9.5	14	14
GTSC-8203R-BS	8	3/8	21	27.5	6	7	9.5	17	14
GTSC-8204R-BS	8	1/2	23	30	6	7	9.5	19	14
GTSC-8301R-BS	10	1/8	22	24	5	7	11	17	17
GTSC-8302R-BS	10	1/4	22	26	8	7	11	17	17
GTSC-8303R-BS	10	3/8	22	27.5	8	7	11	17	17
GTSC-8304R-BS	10	1/2	24	30	8	7	11	19	17
GTSC-8401R-BS	12	1/8	23	24	5	7	12	17	19
GTSC-8402R-BS	12	1/4	23	26	8	7	12	17	19
GTSC-8403R-BS	12	3/8	23	27.5	10	7	12	17	19
GTSC-8404R-BS	12	1/2	25	30	10	7	12	19	19
GTSC-8021R-BS	6.35	1/8	18.5	20	5	7	9.5	14	14
GTSC-8022R-BS	6.35	1/4	18.5	21	5	7	9.5	14	14
GTSC-8023R-BS	6.35	3/8	21	27.5	5	7	9.5	17	14
GTSC-8024R-BS	6.35	1/2	23	30	5	7	9.5	19	14
GTSC-8031R-BS	9.53	1/8	22	24	5	7	11	17	17
GTSC-8032R-BS	9.53	1/4	22	26	8	7	11	17	17
GTSC-8033R-BS	9.53	3/8	22	27.5	8	7	11	17	17
GTSC-8034R-BS	9.53	1/2	24	30	8	7	11	19	17
GTSC-8041R-BS	12.7	1/8	28	24	5	8	12.5	19	21
GTSC-8042R-BS	12.7	1/4	28	26	8	8	12.5	19	21
GTSC-8043R-BS	12.7	3/8	28	27.5	10	8	12.5	19	21
GTSC-8044R-BS	12.7	1/2	28	30	10	8	12.5	19	21