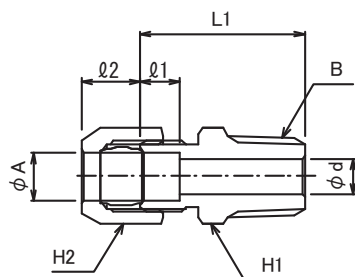

リング式銅管継手(計装用)
■ ハーフユニオン

型 式	銅管外径 A (mm)	管用ねじ B (R)	本体長さ L1 (mm)	最小穴径 d (mm)	差込深さ		対 辺	
					$\phi 1$ (mm)	$\phi 2$ (mm)	H1 (mm)	H2 (mm)
GUC-3-1R-BS	3	1/8	22	2.5	5	6.5	11	11
GUC-4-1R-BS	4	1/8	24	3.5	6	8.5	12	12
GUC-5-1R-BS	5	1/8	26	4	6	8.5	14	14
GUC-5-2R-BS	5	1/4	28	4	6	8.5	14	14
GUC-1101R-BS	6	1/8	26	5	7	9.5	14	14
GUC-1102R-BS	6	1/4	28	5	7	9.5	14	14
GUC-1103R-BS	6	3/8	32	5	7	9.5	19	14
GUC-1104R-BS	6	1/2	36	5	7	9.5	23	14
GUC-1201R-BS	8	1/8	26	6	7	9.5	14	14
GUC-1202R-BS	8	1/4	28	6	7	9.5	14	14
GUC-1203R-BS	8	3/8	32	6	7	9.5	19	14
GUC-1204R-BS	8	1/2	26	6	7	9.5	23	14
GUC-1301R-BS	10	1/8	28	6	7	11	17	17
GUC-1302R-BS	10	1/4	30	8	7	11	17	17
GUC-1303R-BS	10	3/8	33	8	7	11	19	17
GUC-1304R-BS	10	1/2	37	8	7	11	23	17
GUC-1401R-BS	12	1/8	30	6	7	12	19	19
GUC-1402R-BS	12	1/4	32	8	7	12	19	19
GUC-1403R-BS	12	3/8	34	10	7	12	19	19
GUC-1404R-BS	12	1/2	38	10	7	12	23	19
GUC-1021R-BS	6.35	1/8	26	5	7	9.5	14	14
GUC-1022R-BS	6.35	1/4	28	5	7	9.5	14	14
GUC-1023R-BS	6.35	3/8	32	5	7	9.5	19	14
GUC-1024R-BS	6.35	1/2	36	5	7	9.5	23	14
GUC-1031R-BS	9.53	1/8	28	6	7	11	17	17
GUC-1032R-BS	9.53	1/4	30	8	7	11	17	17
GUC-1033R-BS	9.53	3/8	33	8	7	11	19	17
GUC-1034R-BS	9.53	1/2	37	8	7	11	23	17
GUC-1041R-BS	12.7	1/8	33	6	8	12.5	21	21
GUC-1042R-BS	12.7	1/4	35	8	8	12.5	21	21
GUC-1043R-BS	12.7	3/8	37	10	8	12.5	21	21
GUC-1044R-BS	12.7	1/2	41	10	8	12.5	23	21